

## INTERIOR FLOORS WITH RADIANT HEAT OVER WOOD

# RH 130-17 (MODIFIED)

- JOISTS MAX. 16" O.C. / PLYWOOD SUBFLOOR
- PLYWOOD UNDERLAYMENT
- ELECTRIC RADIANT HEAT SYSTEM ENCAPSULATED IN MORTAR
- DEMOFLEX™ TMS MEMBRANE OR DEMOFLEX™ TMS PLUS MEMBRANE
- CERAMIC TILE

**DemoFlex™**  
Tile Management System

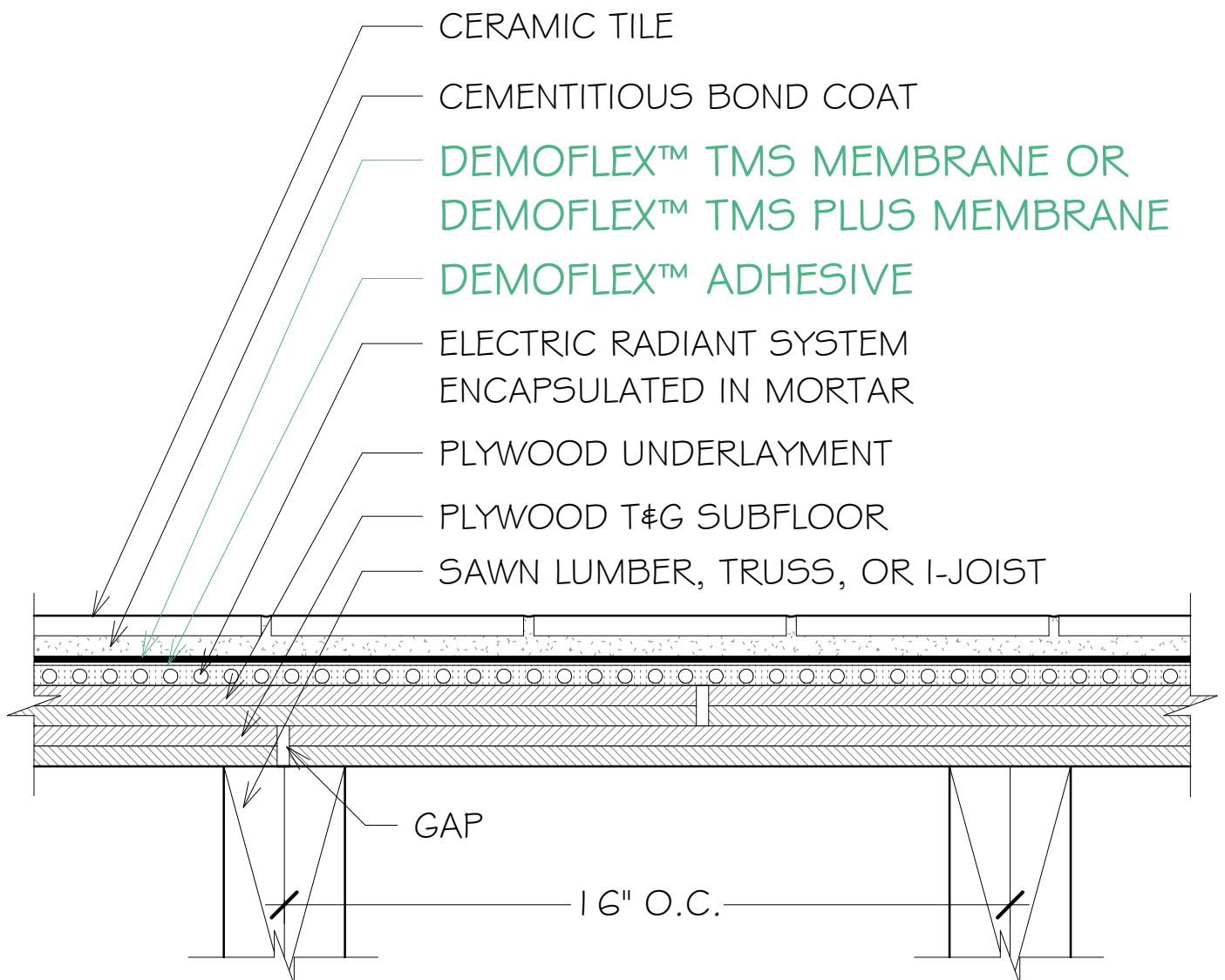

*NUE TILE PROVIDES DEMOFLEX TAPE FOR SEAMS AND PERIMETER OF MEMBRANE.*