

INTERIOR FLOORS WITH RADIANT HEAT OVER WOOD

RH122-17

- JOISTS MAX. 16" O.C. / PLYWOOD SUBFLOOR
- POURED GYPSUM UNDERLAYMENT ENCAPSULATING HYDRONIC TUBING
- DEMOFLEX™ TMS MEMBRANE OR DEMOFLEX™ TMS PLUS MEMBRANE
- CERAMIC TILE, GLASS TILE

DemoFlex™
Tile Management System

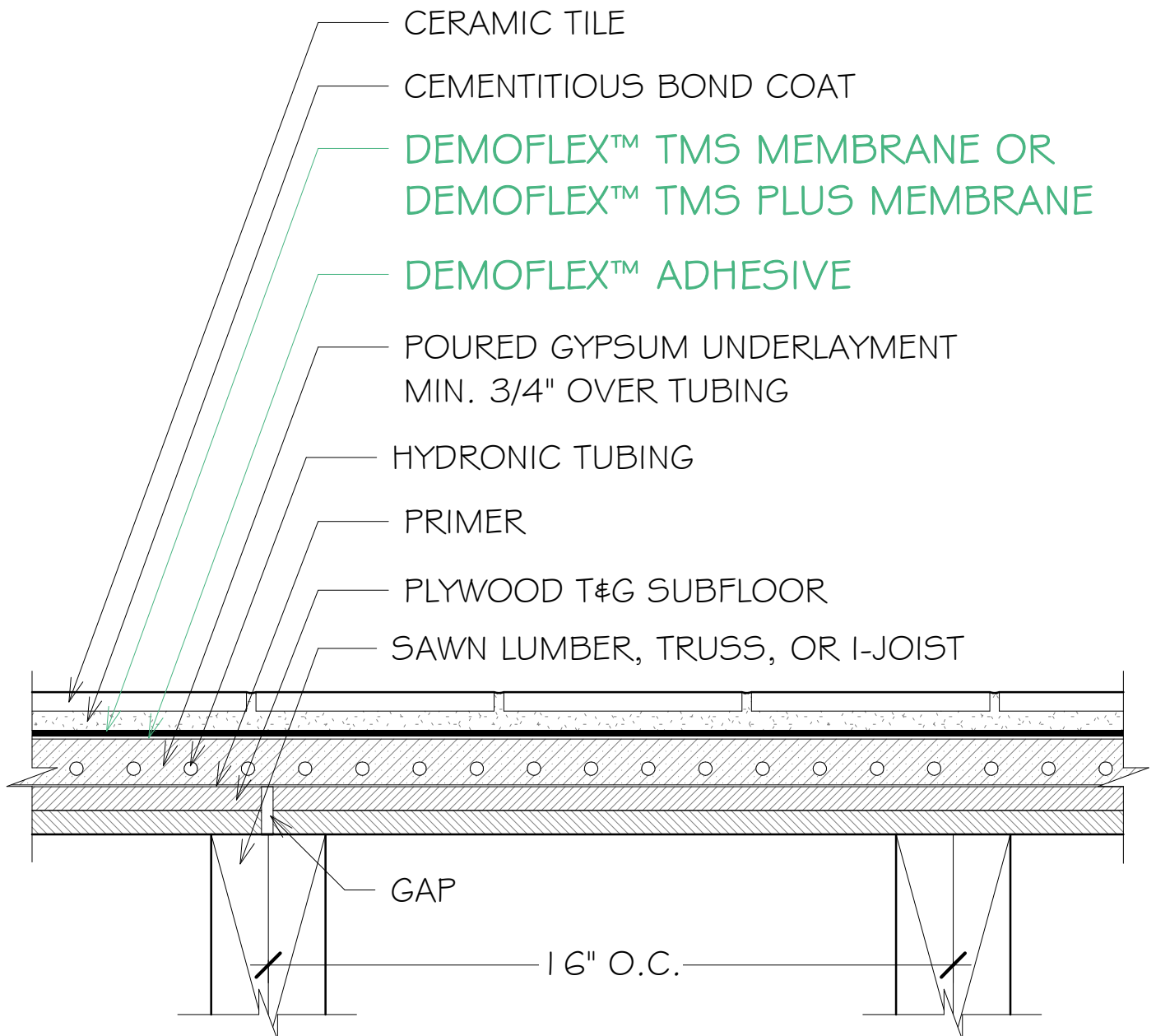

NUE TILE PROVIDES DEMOFLEX TAPE FOR SEAMS AND PERIMETER OF MEMBRANE.