

## INTERIOR FLOORS WITH RADIANT HEAT OVER CONCRETE

# RH 115-17 (MODIFIED)

- ON-GROUND CONCRETE
- ELECTRIC RADIANT HEAT SYSTEM ENCAPSULATED IN PORTLAND CEMENT MORTAR
- DEMOFLEX™ TMS MEMBRANE OR DEMOFLEX™ TMS PLUS MEMBRANE
- CERAMIC TILE

**DemoFlex™**  
Tile Management System

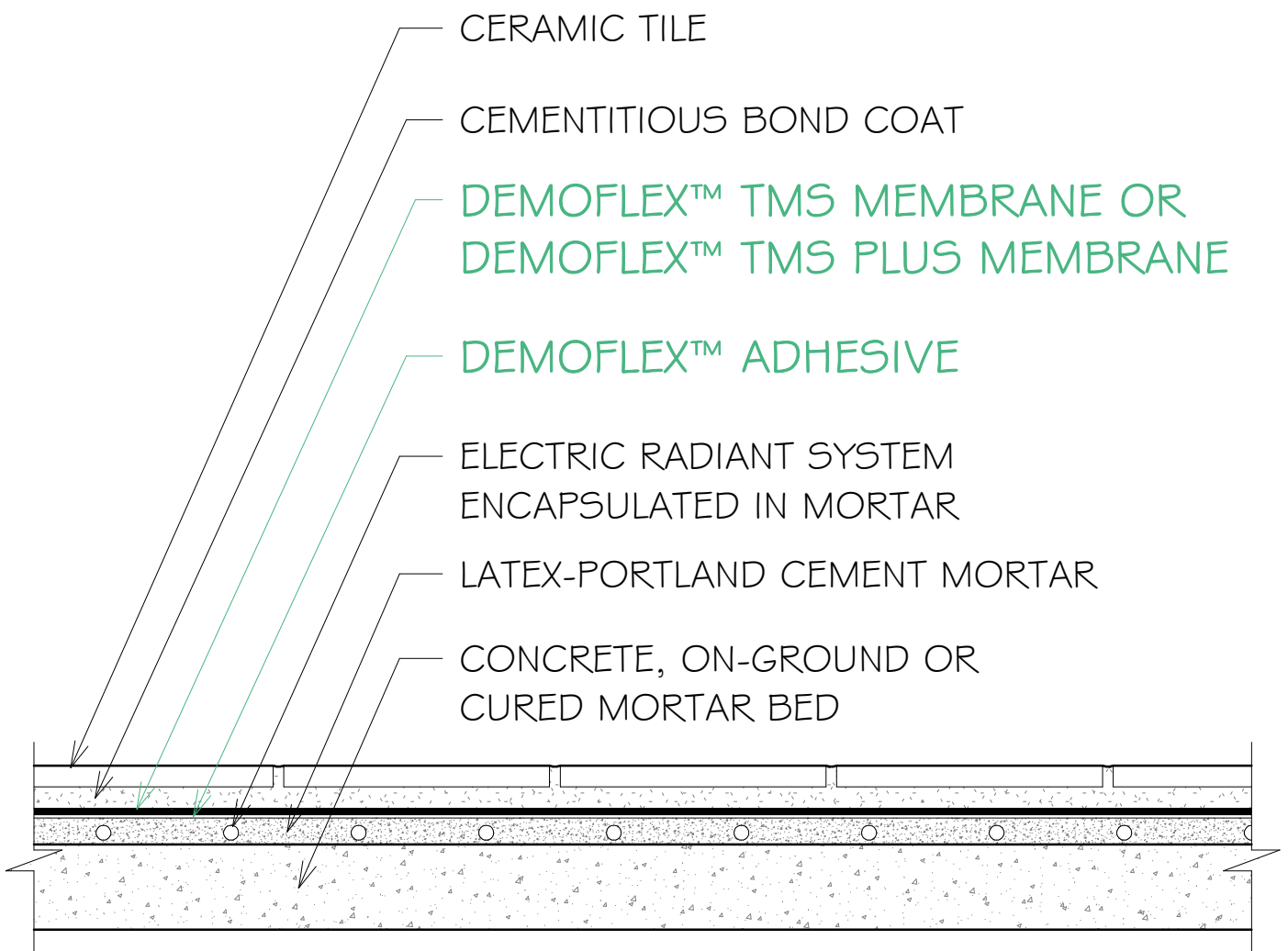

*NUE TILE PROVIDES DEMOFLEX TAPE FOR SEAMS AND PERIMETER OF MEMBRANE.*